

VAC3



dynamic



digital

3 DIFFERENT FILTRATION OPTIONS

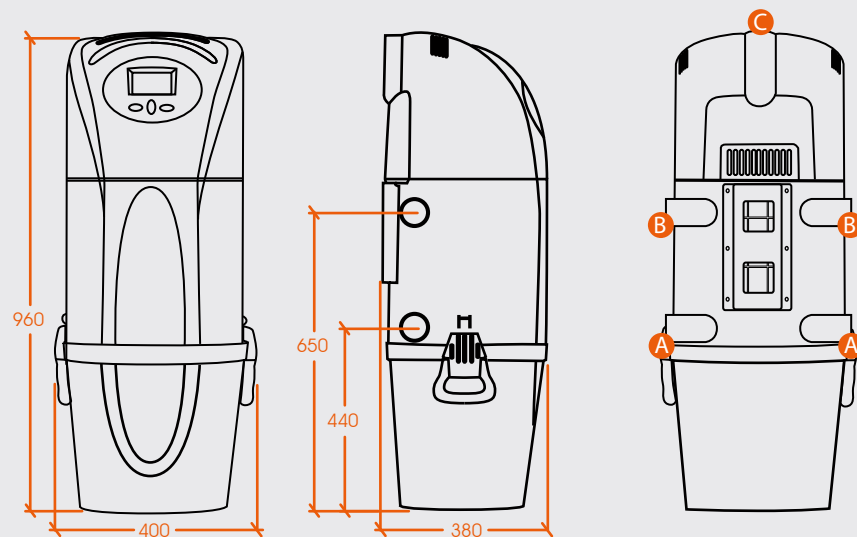

- A AIR INLET FOR DUST BAG AND SELF-CLEANING BAG
- B AIR INLET FOR CARTRIDGE FILTERS
- C EXHAUST

TECHNICAL CHARACTERISTICS

| | VAC ³ DYNAMIC 1.5 | VAC ³ DIGITAL 1.5 | VAC ³ DYNAMIC 1.7 | VAC ³ DIGITAL 1.7 |
|-------------------------------|------------------------------------|------------------------------------|------------------------------------|------------------------------------|
| Reference | UD7100 | UD7120 | UD7110 | UD7130 |
| Power | 1.500 W | | 1.700 W | |
| Max. Consumption | 9,2 A | | 8,2 A | |
| Power supply | 230 V | | 230 V | |
| Frequency | 50/60 Hz | | 50/60 Hz | |
| Airwatts | 750 W | | 740 W | |
| Max. Waterlift | 3.700 mmH ₂ O | | 3.100 mmH ₂ O | |
| Max. Air-flow | 187 m ³ /h | | 289 m ³ /h | |
| Noise Level | <60 dB | | <60 dB | |
| Filtration system | TRIPLE SYSTEM | | TRIPLE SYSTEM | |
| Dust container capacity | 28 L | | 28 L | |
| Digital Display | NO | YES | NO | YES |
| Hepa filter surface area | 6000 cm ² | | 6000 cm ² | |
| Pro-Tecta filter surface area | 1300 cm ² | | 1300 cm ² | |
| Weight | 16 Kg | | 16 Kg | |
| Number of inlet valves | 10 | | 20 | |
| Furthest valve from the unit | 40 m | | 70 m | |
| Size of Home | 500 m ² | | 1.000 m ² | |



CE Mark



RoHS



Insulation Class 2



High energy efficiency



Soft-start



Cartridge filters



Dust Bag



Self-Cleaning Bag